

Datasheet

Echo 172 LED Recessed downlight

1023.4163

24.5ML1JC.00

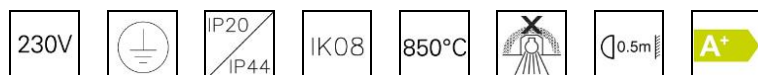
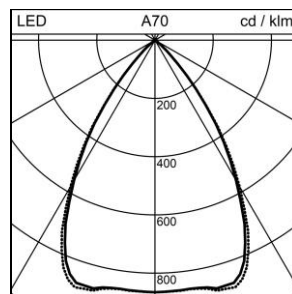
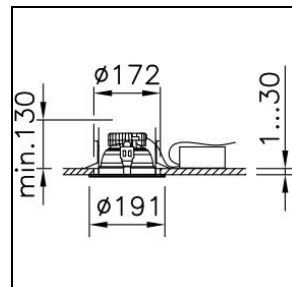

System power	19 W
Source of light	LED (Light Emitting Diode)
Colour temperature	4000 K
Luminaire flux	2000 lm
Ingress Protection	IP20 / IP44
Colour Rendering Index	CRI >90
UGR C0 4H/8H	17.5
UGR C90 4H/8H	17.6
Economic life-time	L90 (B50) 50'000h
Light control	DALI
Finish	white

Recessed downlight Echo 172 LED with LED (Light Emitting Diode), system power: 19 W, luminous flux of luminaire 2000 lm, standby power 0.4 W, CRI >90, 4000 K, SDCM 3, neutral white, L90 (B50) 50'000h, 230 V, direct light emission, housing in aluminium, with ceiling trim, white, with silver reflector, (M), medium beam, 70 °, operating unit included in delivery, DALI,

protection class I, ingress protection IP20 / IP44, glow wire test 850 °C, impact strength: IK 08
 Ø = 191 mm, DAØ = 172 mm, ET = 130 mm