

# Datasheet

## Echo 100 LED Recessed downlight

1023.4123  
24.4FL1JC.00

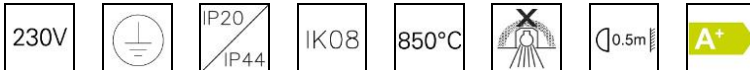
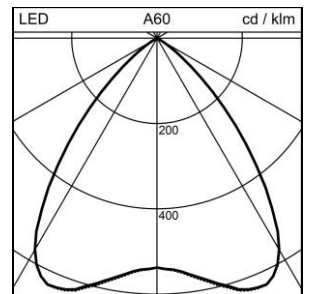
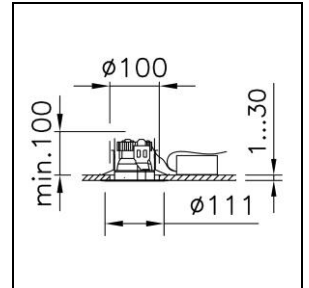
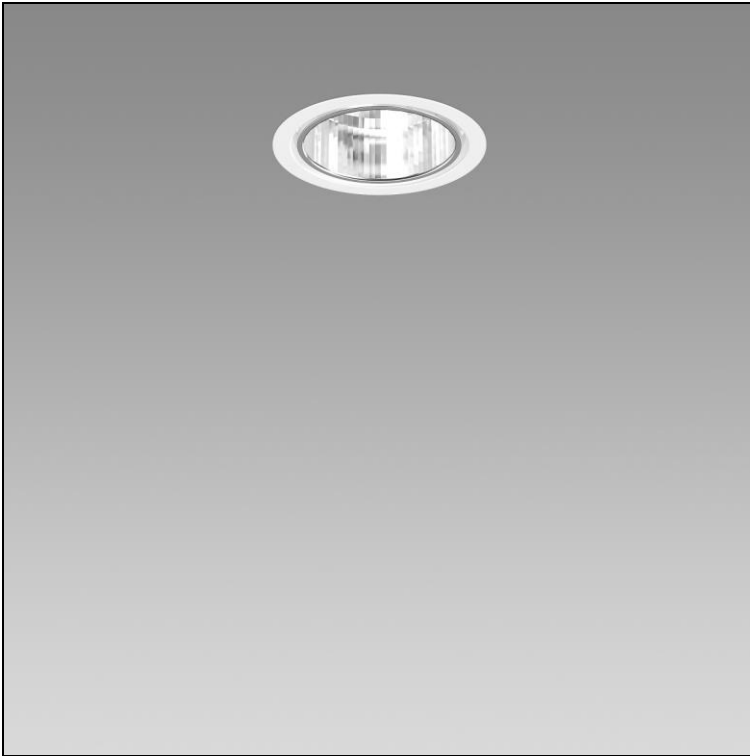

<b>System power</b>	10 W
<b>Source of light</b>	LED (Light Emitting Diode)
<b>Colour temperature</b>	4000 K
<b>Luminaire flux</b>	1000 lm
<b>Ingress Protection</b>	IP20 / IP44
<b>Colour Rendering Index</b>	CRI >90
<b>UGR C0 4H/8H</b>	22.4
<b>UGR C90 4H/8H</b>	22.4
<b>Economic life-time</b>	L90 (B50) 50'000h
<b>Light control</b>	DALI
<b>Finish</b>	white
<b>Weight</b>	0.411 kg

Recessed downlight Echo 100 LED with LED (Light Emitting Diode), system power: 10 W, luminous flux of luminaire 1000 lm, standby power 0.4 W, CRI >90, 4000 K, neutral white, SDCM 3, L90 (B50) 50'000h, 230 V, direct light emission, housing in aluminium, with ceiling trim, white, with silver reflector, (F), wide beam, 80 °, operating unit included in delivery, DALI,

protection class I, ingress protection IP20 / IP44, glow wire test 850 °C, impact strength: IK 08  
Ø = 111 mm, DAØ = 100 mm, ET = 100 mm