

Datasheet

Item LED Recessed ceiling luminaire kit 2003.9178

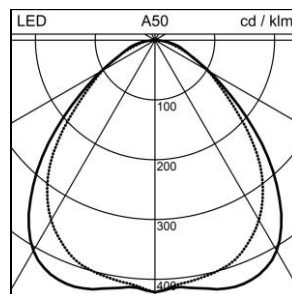
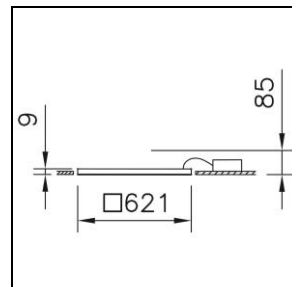

System power	33 W
Source of light	LED (Light Emitting Diode)
Colour temperature	4000 K
Luminaire flux	3800 lm
Ingress Protection	IP20 / IP40
Colour Rendering Index	CRI >80
UGR C0 4H/8H	19.1
UGR C90 4H/8H	18.5
Economic life-time	L80 (B50) 50'000h
Light control	DALI
Finish	white

Recessed ceiling luminaire kit Item LED L2, with LED (Light Emitting Diode), system power: 33 W, luminous flux of luminaire 3800 lm, CRI >80, 4000 K, neutral white, SDCM 3, L80 (B50) 50'000h, 230 V, direct light emission, single-part frame in aluminium, white, RAL 9016, with diffuser, micro-prismatic CLD (Controlled Luminance Diffuser), operating unit included in delivery, DALI, Kit consisting of 1 recessed ceiling luminaire and 1 angle set for installation in hidden systems

protection class I, ingress protection IP20 / IP40, glow wire test 650 °C, module 625, L = 621 mm, B = 621 mm, ET = 85 mm