

Datasheet

Splash Ex Explosion-proof damp-proof diffuser luminaire

2008.6702

SPLASH EX 1272 LED5100-840 WB PC ONF

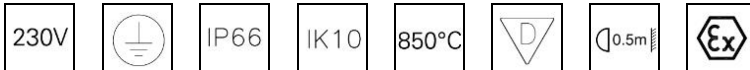
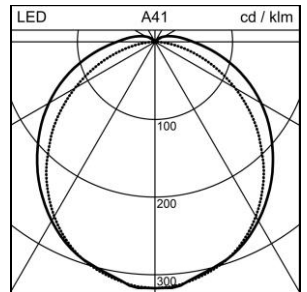
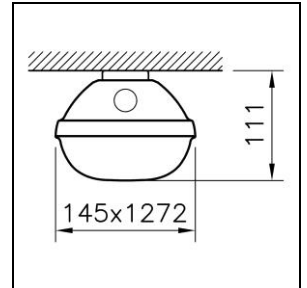

System power	43 W
Luminaire flux	5100 lm
Colour temperature	4000 K
CRI	CRI > 80
UGR C0 4H/8H	24
UGR C90 4H/8H	22
Economic life-time	L90 50'000 h
Light control	ON/OFF
Ingress Protection	IP66
Finish	light grey
Weight	3.1 kg

Explosion-proof damp-proof diffuser luminaire Splash Ex for EX Zone 2 + 22, for surface, wall and pendant mounting, with LED, system power: 43 W, luminous flux of luminaire 5100 lm, colour rendering index CRI > 80, colour temperature 4000 K, neutral white, colour tolerances SDCM 3, lifetime LED L90 50'000 h, photobiological safety: the luminaire poses no danger (RG0), 230 V, direct light emission, wide beam, 1 integral control gear, ON/OFF, housing in polycarbonate (PC), light grey and diffuser in polycarbonate (PC), opal, with chrome steel clamps,

protection class I, ingress protection IP66, glow wire test 850 °C, impact strength: IK 10, service temperature range -25 to +55 °C, II 3G Ex ec IIC T6 Gc (Zone 2), II 3 D Ex tc IIIC T85°C Dc (Zone 22) this product contains a light source of energy efficiency class D and EPREL registration number: 1110803
L = 1272 mm, B = 145 mm, H = 111 mm