

## Datasheet

### Guell 2 LED Floodlight 2001.2835

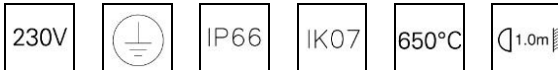
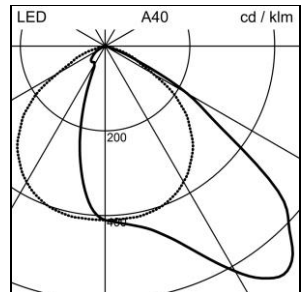
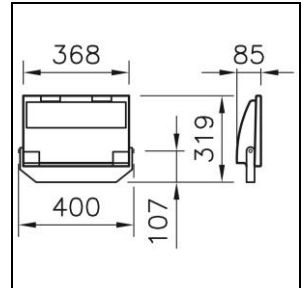

<b>System power</b>	105 W
<b>Source of light</b>	LED (Light Emitting Diode)
<b>Colour temperature</b>	4000 K
<b>Luminaire flux</b>	11551 lm
<b>Ingress Protection</b>	IP66
<b>Colour Rendering Index</b>	CRI >80
<b>Economic life-time</b>	L70 (B10) 130'000h
<b>Light control</b>	ON/OFF
<b>Finish</b>	metallic grey
<b>Weight</b>	2.5 kg

Floodlight Guell 2 LED with LED (Light Emitting Diode), system power: 105 W, luminous flux of luminaire 11551 lm, CRI >80, 4000 K, neutral white, SDCM 3, L70 (B10) 130'000h, 230 V, asymmetric beam, 1 integral control gear, ON/OFF, luminaire housing in die-cast aluminium, metallic grey, with cover screen in safety glass ESG, clear, with mounting bracket,

protection class I, ingress protection IP66, glow wire test 650 °C, impact strength: IK 07, B = 368 mm, T = 85 mm, total height = 319 mm