

## Datasheet

### Isigo LED Ceiling and wall mounted luminaire

2002.3823

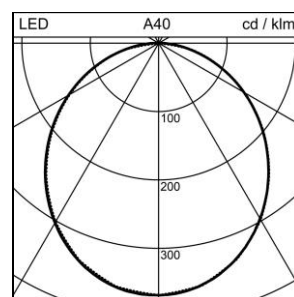
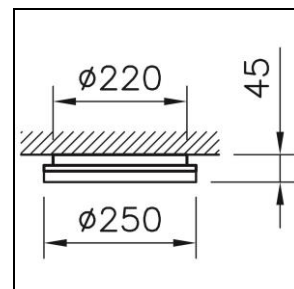

<b>System power</b>	15 W	Ceiling and wall mounted luminaire Isigo LED with LED (Light Emitting Diode), system power: 15 W, luminous flux of luminaire 1500 lm, CRI >85, 4000 K, neutral white, SDCM 3, L80 (B10) 50'000h, RG 0 - no risk, 230 V, direct light emission, housing in polycarbonate (PC), white, RAL 9016, with opal diffuser, 110 °, 1 integral control gear, ON/OFF, Colour temperature 3000K or 4000K can be set directly on the luminaire  protection class II, ingress protection IP54, glow wire test 850 °C, impact strength: IK 10 Ø = 250 mm, H = 45 mm
<b>Source of light</b>	LED (Light Emitting Diode)	
<b>Colour temperature</b>	4000 K	
<b>Luminaire flux</b>	1500 lm	
<b>Ingress Protection</b>	IP54	
<b>Colour Rendering Index</b>	CRI >85	
<b>UGR C0 4H/8H</b>	23.1	
<b>UGR C90 4H/8H</b>	23.5	
<b>Economic life-time</b>	L80 (B10) 50'000h	
<b>Light control</b>	ON/OFF	
<b>Finish</b>	white	
<b>Weight</b>	0.687 kg	