

Datasheet

Echo 100 LED Recessed downlight

1023.4127

24.4ML1JC.00

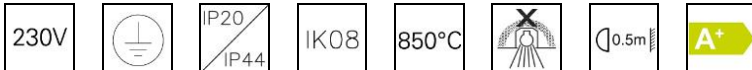
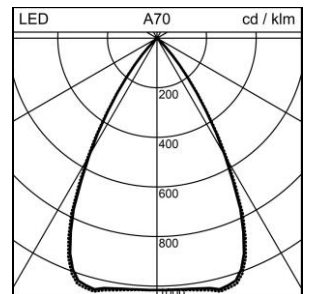
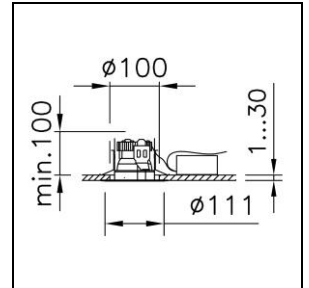
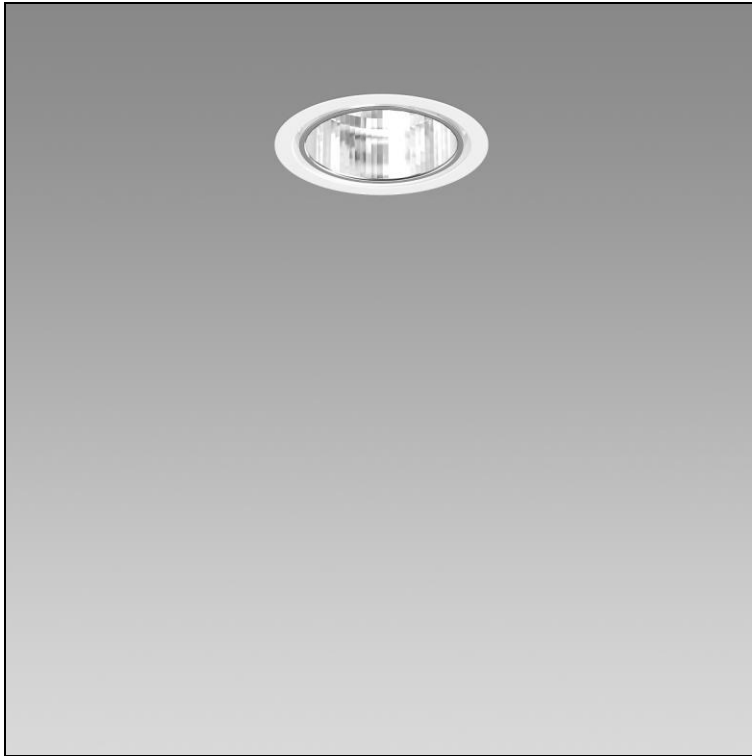

System power	10 W
Source of light	LED (Light Emitting Diode)
Colour temperature	4000 K
Luminaire flux	1000 lm
Ingress Protection	IP20 / IP44
Colour Rendering Index	CRI >90
UGR C0 4H/8H	17.6
UGR C90 4H/8H	17.8
Economic life-time	L90 (B50) 50'000h
Light control	DALI
Finish	white
Weight	0.411 kg

Recessed downlight Echo 100 LED with LED (Light Emitting Diode), system power: 10 W, luminous flux of luminaire 1000 lm, standby power 0.4 W, CRI >90, 4000 K, neutral white, SDCM 3, L90 (B50) 50'000h, 230 V, direct light emission, housing in aluminium, with ceiling trim, white, with silver reflector, (M), medium beam, 60 °, operating unit included in delivery, DALI,

protection class I, ingress protection IP20 / IP44, glow wire test 850 °C, impact strength: IK 08
 Ø = 111 mm, DAØ = 100 mm, ET = 100 mm